

TKR5336B

REVISED BRAKE LINKAGE

STEP 1

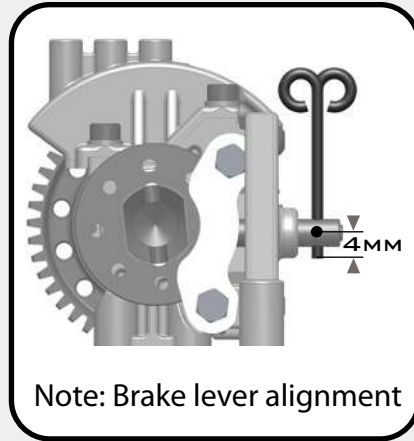
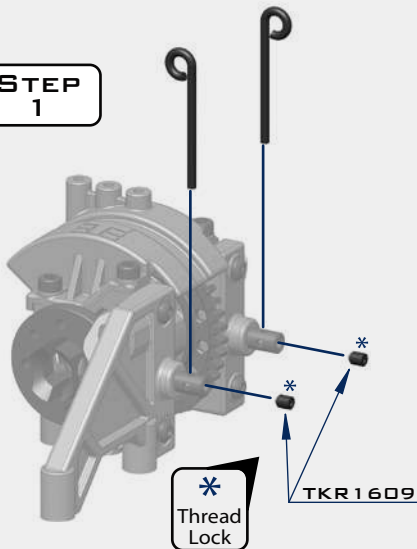

STEP 2

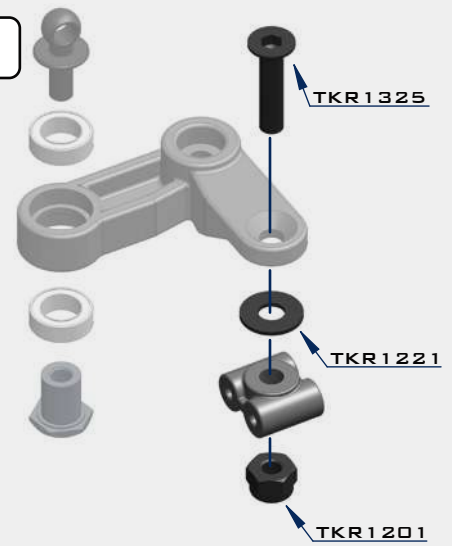

Note: Do not overtighten.
Parts should rotate freely.

STEP 3

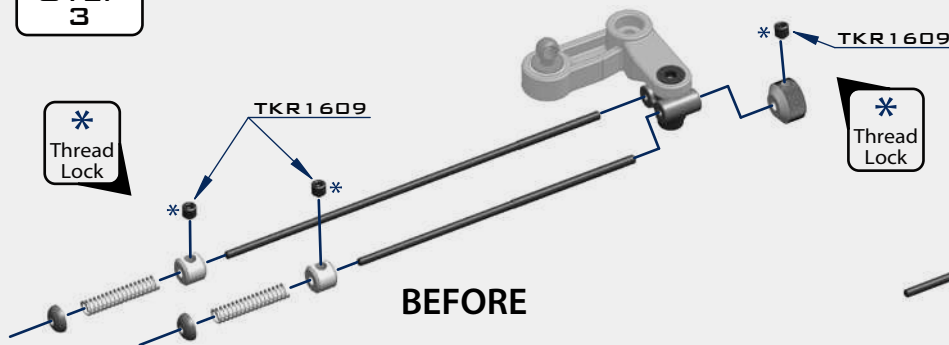

Note: Set collars up to appear close to this diagram.

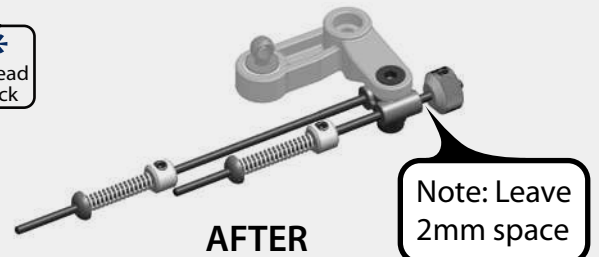

STEP 4

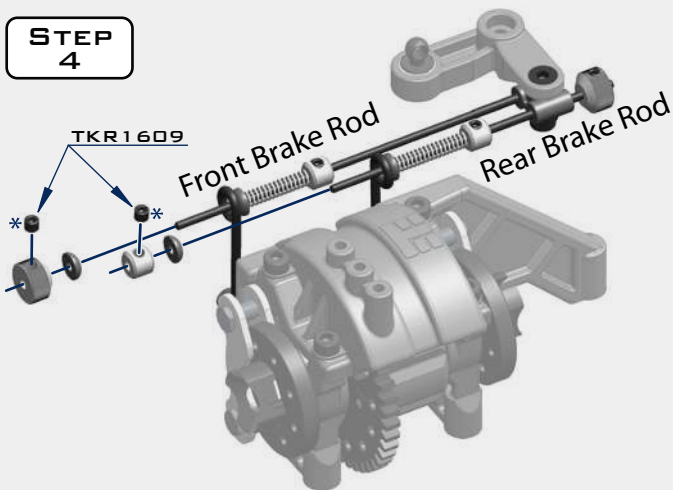

STEP 5

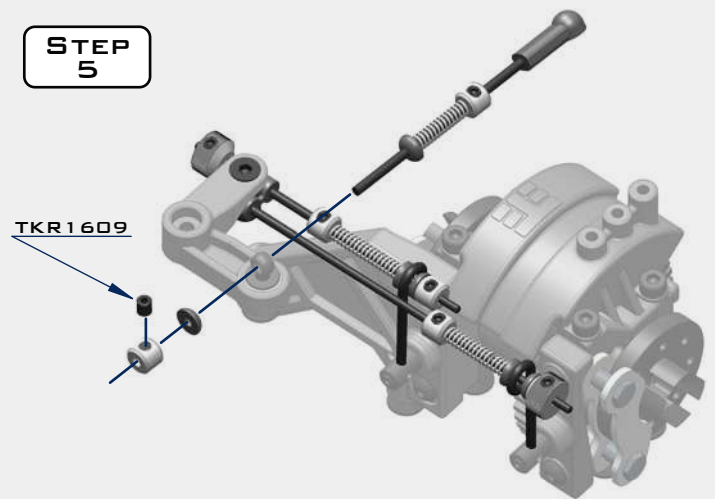

NOTES:

- Align the carburetor so it forms a straight line to the servo linkage, with the servo in the neutral position
- Attach all linkages before setting brake bias
- All collars should be snug against the springs without being compressed
- Turn on radio equipment for final adjustment of collars, total brake force, F/R brake bias, and throttle EPA
- Brakes should be fully disengaged and the carburetor should be fully closed at neutral position

STEP 6

