

TKR5147

COMPLETE CENTER DIFFERENTIAL

(OVERVIEW)

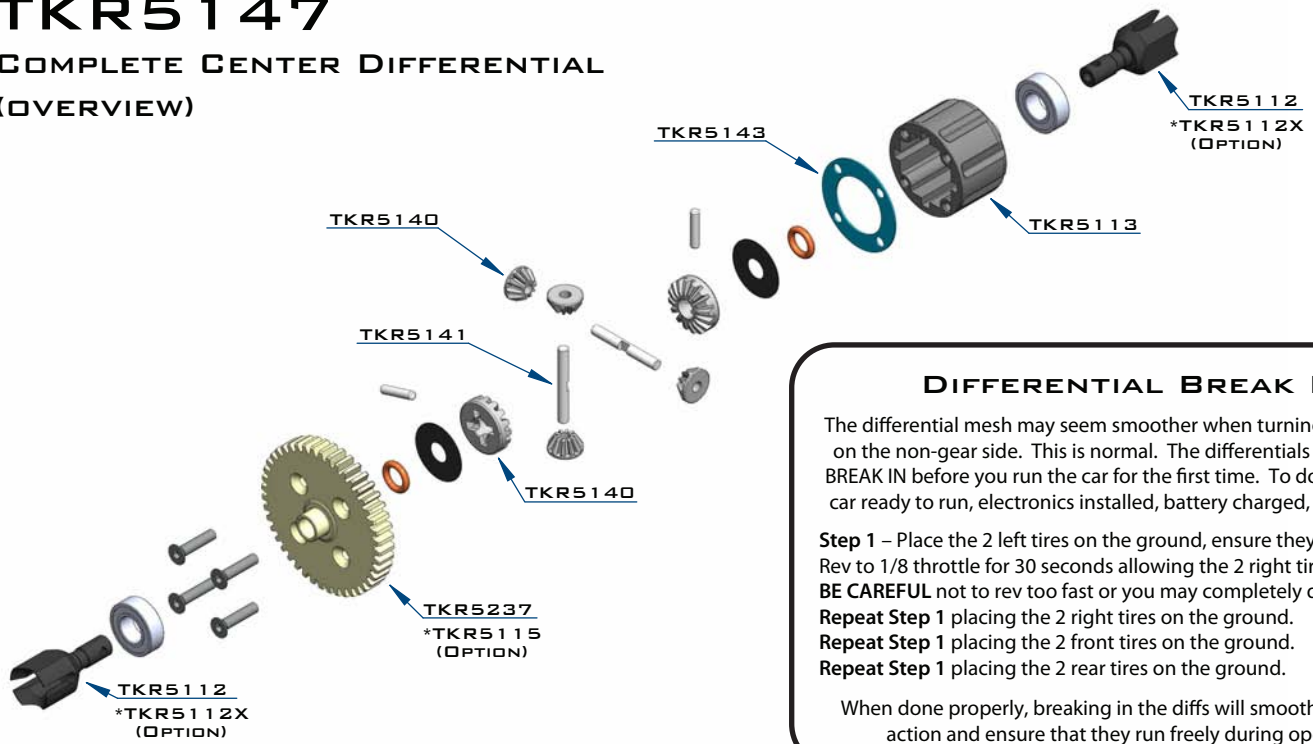

DIFFERENTIAL BREAK IN

The differential mesh may seem smoother when turning the outdrive on the non-gear side. This is normal. The differentials will **NEED TO BREAK IN** before you run the car for the first time. To do this Get your car ready to run, electronics installed, battery charged, ready to go...

- Step 1** – Place the 2 left tires on the ground, ensure they do not move. Rev to 1/8 throttle for 30 seconds allowing the 2 right tires to ‘diff out’ **BE CAREFUL** not to rev too fast or you may completely damage the diff.
- Repeat Step 1** placing the 2 right tires on the ground.
- Repeat Step 1** placing the 2 front tires on the ground.
- Repeat Step 1** placing the 2 rear tires on the ground.

When done properly, breaking in the diffs will smooth out the diff action and ensure that they run freely during operation.

STEP 1

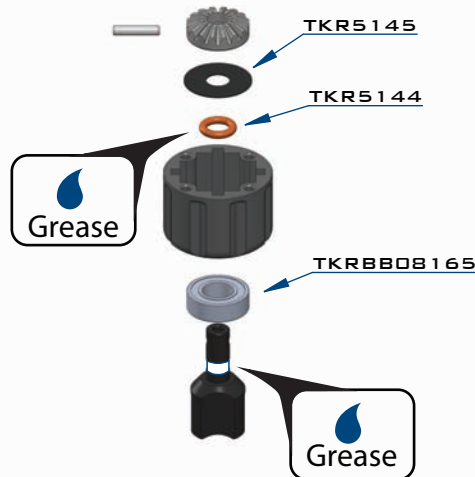

STEP 2

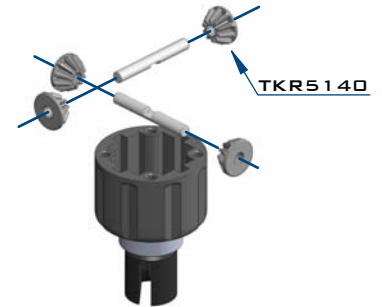

STEP 4

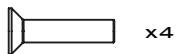
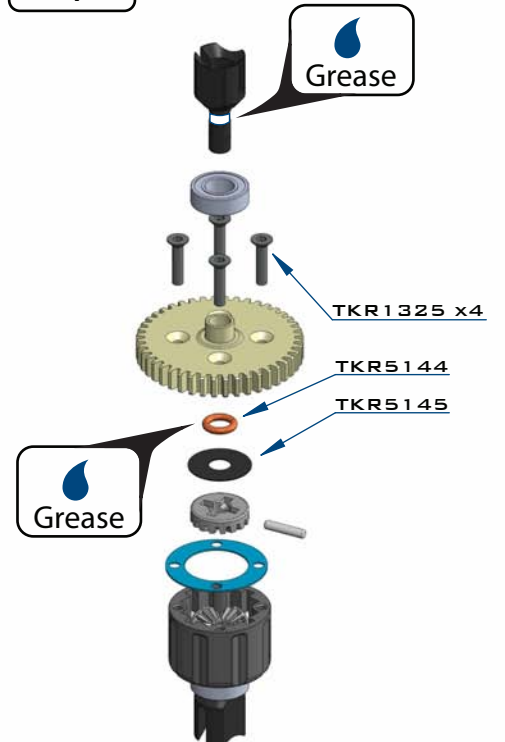

TKR1325
M3X14MM FLAT HEAD SCREW



TKR5144
DIFFERENTIAL O-RINGS

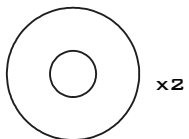

TKR5145
DIFFERENTIAL SHIMS (6X17MM)



TKRBB08165
BALL BEARING(8X16X5MM)

STEP 3

